

# LS7 Series <Key Changeable Cylinder>

## Outline of LS7 series

- High security cam lock with special key change mechanism for use in Vending Machines and Casino Gaming Devices
- Superior operational performance and anti-picking due to the use of sidebar technology
- Key codes can be changed on the fly with a simple turn of the old and then the new change keys
- Lock dimensions are based on the Japan Vending Machine Manufacturers Association Standard S size, and also fits the U.S. Double "D" cut for Gaming Machines
- Easy operation of keys with almost no binding on insertion and removal, thus reducing key wear and extending product life
- Both Keys and Locks can be serial stamped for simple tracking and auditing
- When changing the key code on the lock, the tail and cam remain in the locked position, thus maintaining security and improving efficiency
- Locks are shipped with an "off-floor" code for lockable functionality during set-up or EGM factory installation and ready for immediate code change

## Mechanical specification

### Cylinder

- Disk tumbler method with side bar (7 lines tumbler, 4 different increment)
- Practical key combinations: Approx 10,000
- Turning direction (R or L) can be changed in the field

### Key

- Patented key ward prevents unauthorized key duplication
- User friendly reversible key for easy insertion
- Keys are made of nickel-silver for increased durability



## Easy 4 – step process for key changing

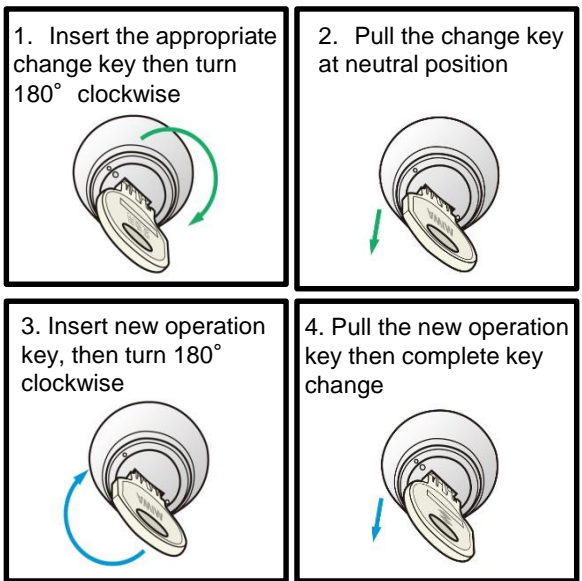

## Mechanical structure of LS7

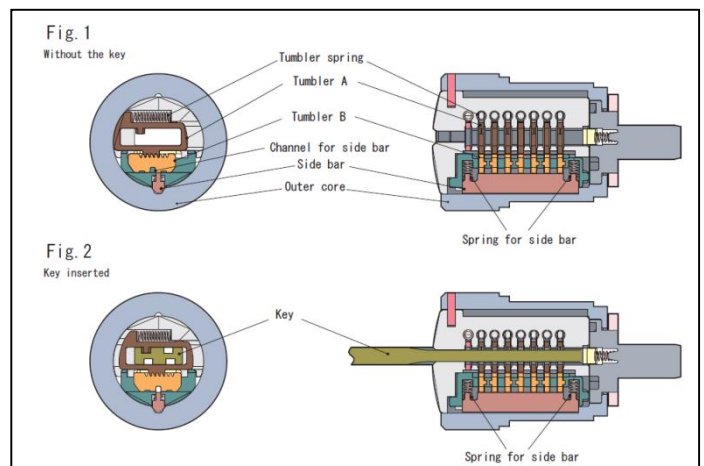

Type	Description
LS7-CYS	Short length, Right/Left turn, 1 key pull
LS7-CYM	Middle length, Right/Left turn, 1 key pull
LS7-CYL	Long length, Right/Left turn, 1 key pull
LS7-CYL2	Long length, Right turn only, 2 Key pulls
LS7-CK	Operation key
LS7-CCK	Change key